

| |
|---|
| AIRCRAFT TECHNICAL SPECIFICATION |
|---|

Report generated 13 Apr 2018

GENERAL DESCRIPTION

| | | | | | |
|-----------------|------|---------------------|---------------|--------------|-------------|
| Serial Number | xxxx | Line No. | | TSN | 25,484 |
| Aircraft Type | A320 | Registration | xxxxx | CSN | 16,434 |
| Aircraft Model | 200 | Date of Manufacture | 21 Dec 2010 | Status As Of | 31 Mar 2018 |
| Aircraft Series | 214 | ETOPS | ETOPS capable | | |

OPERATION

| | | | |
|-----------------------------|----------|-----------------|-------------|
| Operator / Storage Facility | xxxxxx | AOC Regulation | xxxxxx |
| Delivery Date | Dec 2010 | Expiration Date | 20 Dec 2018 |
| Previous Operator(s) | N/A | | |

WEIGHTS

| | <u>Pounds</u> | <u>Kilograms</u> |
|--------------------------|---------------|------------------|
| Maximum Taxi Weight | 170,638 | 77,400 |
| Maximum Take-Off Weight | 169,757 | 77,000 |
| Maximum Landing Weight | 145,506 | 66,000 |
| Maximum Zero Fuel Weight | 137,789 | 62,500 |
| Basic Empty Weight | 94,175 | 42,717 |
| Date of Last Weighing | 10/11/2014 | |
| Weight Variant 012 | | |

FUEL

| | <u>Pounds</u> | <u>Kilograms</u> | <u>Gallons</u> |
|-------------------------|---------------|------------------|----------------|
| Standard Fuel Capacity | 42,210 | 19,141 | 6,300 |
| Auxiliary Tank Capacity | N/A | N/A | N/A |

INTERIOR CONFIGURATION

| | | | |
|-----------------------|-----------------|-----------------------|--------------------|
| Galleys | G1, G2, G5 | Catering Standard | Atlas |
| Lavatories | LA, LD, LE | Cockpit Configuration | EFIS |
| Cabin Attendant Seats | 6 | | |
| Seats | <u>Quantity</u> | <u>Manufacturer</u> | <u>Part Number</u> |
| Business Class | 16 | Recaro | 409-21-21-11 |
| Economy | 120 | Recaro | 3510A549-32-051 |

MISCELLANEOUS

| | | | |
|------------------------|-----------------|---------------------|--------------------|
| Airstairs | N/A | Cargo Configuration | Bulk |
| Noise Compliance | Stage 4 | Floor Path Marking | Yes |
| Approach / Landing Cat | CAT III Capable | Entertainment | Panasonic Avionics |

Modification Status

| | <u>Installed</u> | <u>Approval</u> |
|------------------------|------------------|-----------------|
| 8.33 KHz Spacing | Yes | Build Standard |
| RVSM Approved | Yes | Build Standard |
| 406 ELT | Yes | Build Standard |
| Cargo Fire Suppression | Yes | Build Standard |
| Flight Deck Door | Yes | Build Standard |
| Re-enforcement | | |
| EGPWS | Yes | Build Standard |
| FM immunity | Yes | Build Standard |

No warranty is made or implied as to the accuracy or completeness of the information herein.
Such information is subject to change and to verification upon inspection of the aircraft and its records

**AIRCRAFT TECHNICAL
SPECIFICATION**

Report generated 13 Apr 2018

| | | |
|--------------------------|-----|----------------|
| SATCOM | Yes | |
| Flight Deck Surveillance | Yes | Build Standard |
| Enhanced Mode S | Yes | Build Standard |
| TCAS II C.7.0 | Yes | Build Standard |

No warranty is made or implied as to the accuracy or completeness of the information herein.
Such information is subject to change and to verification upon inspection of the aircraft and its records

| |
|---|
| AIRCRAFT TECHNICAL SPECIFICATION |
|---|

Report generated 13 Apr 2018

AIRFRAME

OEM Maintenance Program

| <u>Check</u> | <u>Interval Hours</u> | <u>Interval Cycles</u> | <u>Interval</u> | <u>Program Basis</u> |
|---------------|-----------------------|------------------------|-----------------|----------------------|
| 12 Year Check | | | 144.00 Months | Hardtime |
| 6 Year Check | | | 72.00 Months | Hardtime |
| C Check | 7,500 | 5,000 | 24.00 Months | Hardtime |

Operator Maintenance Program

| <u>Check</u> | <u>Operator Equivalent</u> | <u>Interval Hours</u> | <u>Interval Cycles</u> | <u>Interval</u> | <u>Program Basis</u> |
|---------------|----------------------------|-----------------------|------------------------|-----------------|----------------------|
| 12 Year Check | None | | | | |
| 6 Year Check | None | | | | |
| C Check | C Check | 7,500 | 5,000 | 24.00 | Hardtime |

Maintenance Status

Total Time 25,484
Total Cycles 16,434
Status As Of 31 Mar 2018

| <u>Check</u> | <u>Maintenance Performer</u> | <u>Date of Check</u> | <u>TT @ Check</u> | <u>TC @ Check</u> | <u>Est Date Next Check</u> |
|---------------|------------------------------|----------------------|-------------------|-------------------|----------------------------|
| 12 Year Check | N/A | Not Performed | N/A | N/A | Dec 22 |
| 6 Year Check | xxxxxxx | 13 Oct 16 | 19,810.47 | 12,903 | Oct 22 |
| C Check | xxxxxxx | 13 Oct 16 | 19,810.47 | 12,903 | Sep 18 |

LANDING GEAR

Maintenance Program

Manufacturer Messier Dowty

| <u>Description</u> | <u>Interval Hours</u> | <u>Interval Cycles</u> | <u>Interval</u> | <u>Program Basis</u> |
|--------------------------------|-----------------------|------------------------|-----------------|----------------------|
| NLG - Landing Gear Overhaul | | 20,000 | 120.00 Months | Hardtime |
| LH MLG - Landing Gear Overhaul | | 20,000 | 120.00 Months | Hardtime |
| RH MLG - Landing Gear Overhaul | | 20,000 | 120.00 Months | Hardtime |

Maintenance Status

| | <u>Nose</u> | <u>LH Wing</u> | <u>RH Wing</u> |
|----------------------|---------------|----------------|----------------|
| Part Number | D23757550-7 | 201582001-050 | 201582002-050 |
| Serial Number | B4051 | MDG6393 | MDG6394 |
| Date Installed | 21 Dec 2010 | 21 Dec 2010 | 21 Dec 2010 |
| TSN | 25,484 | 25,484 | 25,484 |
| CSN | 16,434 | 16,434 | 16,434 |
| Status As Of | 31 Mar 2018 | 31 Mar 2018 | 31 Mar 2018 |
| Date Overhauled | Not Performed | Not Performed | Not Performed |
| TSO | N/A | N/A | N/A |
| CSO | N/A | N/A | N/A |
| Estimated Next Visit | Sep 2019 | Sep 2019 | Sep 2019 |

No warranty is made or implied as to the accuracy or completeness of the information herein.
Such information is subject to change and to verification upon inspection of the aircraft and its records

| |
|---|
| AIRCRAFT TECHNICAL SPECIFICATION |
|---|

Report generated 13 Apr 2018

ENGINE

| | | | |
|--------------|-------------|---------------|--------|
| Manufacturer | CFMI | Engine Thrust | 27,000 |
| Engine Model | CFM56-5B4/3 | | |

Engine Position 1 Maintenance Status

| | | | | | |
|-------|--------|---------------|-------------|-----------------|-------------|
| ESN 1 | xxxxxx | Date Last S.V | 12 Feb 2015 | LLP Limiter | Multiple |
| TSN | 24,557 | TS Last S.V | 11,200 | Limiting Cycles | 4,327 |
| CSN | 15,673 | CS Last S.V | 7,402 | Status As Of | 31 Mar 2018 |

Engine Position 2 Maintenance Status

| | | | | | |
|-------|--------|---------------|-------------|-----------------|-------------|
| ESN 2 | xxxxxx | Date Last S.V | 29 Oct 2014 | LLP Limiter | Multiple |
| TSN | 22,866 | TS Last S.V | 12,404 | Limiting Cycles | 5,525 |
| CSN | 14,475 | CS Last S.V | 8,334 | Status As Of | 31 Mar 2018 |

APU

| | |
|---------------|-----------------------------|
| Manufacturer | Honeywell International Inc |
| Type / Model | GTCP131-9A |
| Serial Number | P-4638 |

Contracted APU Maintenance Status

| | |
|-------------------------|----------------------|
| Date of Last Overhaul | 21 Oct 2016 |
| Date of Last Shop Visit | 21 Oct 2016 |
| Reason for Shop Visit | Internal oil Leakage |

No warranty is made or implied as to the accuracy or completeness of the information herein.
Such information is subject to change and to verification upon inspection of the aircraft and its records

| |
|---|
| AIRCRAFT TECHNICAL SPECIFICATION |
|---|

Report generated 13 Apr 2018

EQUIPMENT

| ATA | Description | Qty | Manufacturer | Model/PN |
|------------|---|------------|--------------------------------|---------------------|
| 22 | Flight Augmentation Computer - 1CC1/1CC2 | 2 | Thales Avionics | B397BAM0621 |
| 22 | Flight Control Unit - 2CA | 1 | Thales Avionics | C12850BC03 |
| 22 | Flight Management Computer - 1CA1/1CA2 | 2 | Thales Avionics | C13043AA05 |
| 22 | MCDU - 3CA1/3CA2 | 2 | Thales Avionics | C19266DA01 |
| 23 | Cockpit Voice Recorder - 1RK | 1 | Honeywell International Inc | 980-6022-001 |
| 23 | HF Communications Transceiver - 3RE1 | 1 | Rockwell Collins | 822-0990-003 |
| 23 | VHF Transceiver - 1RC1/1RC2/1RC3 | 3 | Rockwell Collins | 822-1287-120 |
| 25 | Emergency Locator Transmitter - 7559MM/7560MM | 2 | Kannad | S1823502-05 |
| 25 | Emergency Locator Transmitter - 110MX Alternate part number also fitted, see below | 1 | Kannad | S1821502-02 |
| 31 | CFDIU - 1TW | 1 | Thales Avionics | C12860AA02 |
| 31 | Display Management Computer - 1WT2/1WT1/1WT3 | 3 | Thales Avionics | 1982660116 |
| 31 | Display Unit - 2WT1/3WT2/3WT1/4WT1/2WT2/4WT2 | 6 | Thales Avionics | C19298AF05 |
| 31 | SSFDR - 1TU | 1 | Honeywell International Inc | 2100-4043-02 |
| 32 | Brake Assy - MLG - 2641GM / 2642GM / 2643GM / 2644G | 4 | Messier Bugatti | C20225508/C20225510 |
| 32 | Fan Brakes - 2866GM/2867GM/2868GM/2869GM | 4 | Technofan | RU1502U01 |
| 32 | Tyre MLG - 2651GM/2649GM/2650GM/2652GM | 4 | Michelin Air X | M01103 |
| 32 | Tyre NLG - 2659GM/2660GM | 2 | Michelin Air X | M08201 |
| 32 | Wheel Assy - MLG - 2650GM | 1 | Messier Bugatti | C20195162 |
| 32 | Wheel Assy - MLG - 2649GM/2651GM/2652GM | 3 | Messier Bugatti | C20195162 |
| 32 | Wheel Assy - NLG - 2659GM | 1 | Goodrich | 3-1531-3 |
| 32 | Wheel Assy - NLG - 2660GM | 1 | Goodrich | 3-1531-3 |
| 34 | ADF Receiver - 2RP1 | 1 | Rockwell Collins | 822-0299-020 |
| 34 | ADIRU - 1FP1/1FP2/1FP3 | 3 | Honeywell International Inc | HG2030BE03 |
| 34 | Air Data Module - 19FP1 / 19FP2 / 19FP3 / 19FP4 /1 | 8 | Honeywell International Inc | PG1152BC02 |
| 34 | DME Interrogator - 2SD2/2SD1 | 2 | Rockwell Collins | 822-0329-020 |
| 34 | ISIS - 22FN | 1 | Thales Avionics | C16221VA01 |
| 34 | MMR Receiver - 40RT2/40RT1 | 2 | Rockwell Collins | 822-1821-430 |
| 34 | Radio Altimeter - Transceiver - 2SA2/2SA1 | 2 | Rockwell Collins | 822-0334-020 |
| 34 | T2CAS - 100SG | 1 | L-3 Communications | 9000000-11414 |
| 34 | VOR/Marker Receiver - 3RS1/3RS2 | 2 | Rockwell Collins | 822-0297-020 |
| 34 | Weather Radar Tx/Rx - 1SQ1 | 1 | Rockwell Collins | 822-1710-214 |
| 73 | Engine ECU - LH/RH | 2 | CFMI | 2123M56P04 |

Comments

For technical inquiries please contact:

Phone:
Mobile:
Fax:
e-mail:

No warranty is made or implied as to the accuracy or completeness of the information herein.
Such information is subject to change and to verification upon inspection of the aircraft and its records

AIRCRAFT TECHNICAL SPECIFICATION

Report generated 13 Apr 2018

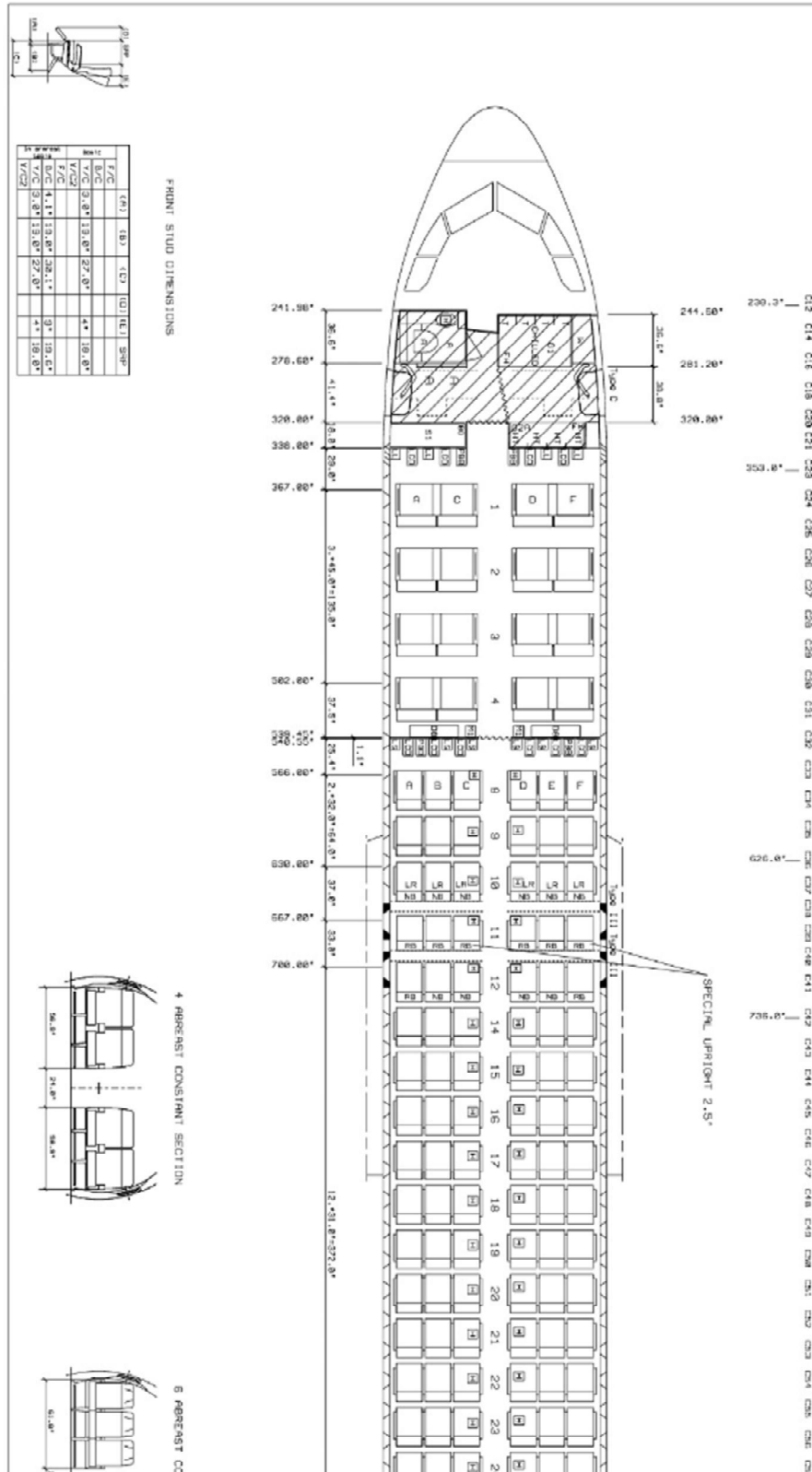

| |
|---|
| AIRCRAFT TECHNICAL SPECIFICATION |
|---|

Report generated 13 Apr 2018

GENERAL DESCRIPTION

| | | | | | |
|-----------------|------|---------------------|------------------|--------------|-------------|
| Serial Number | xxxx | Line No. | | TSN | 26,052 |
| Aircraft Type | A320 | Registration | xxxxxx | CSN | 16,567 |
| Aircraft Model | 200 | Date of Manufacture | 22 Dec 2010 | Status As Of | 31 Mar 2018 |
| Aircraft Series | 214 | ETOPS | 120 Mins Capable | | |

OPERATION

| | | | |
|-----------------------------|-------------|-----------------|-------------|
| Operator / Storage Facility | xxxxxxxxxx | AOC Regulation | xxxxxxxxxx |
| Delivery Date | 22 Dec 2010 | Expiration Date | 21 Dec 2018 |
| Previous Operator(s) | N/A | | |

WEIGHTS

| | <u>Pounds</u> | <u>Kilograms</u> |
|--------------------------|---------------|------------------|
| Maximum Taxi Weight | 170,638 | 77,400 |
| Maximum Take-Off Weight | 169,757 | 77,000 |
| Maximum Landing Weight | 145,506 | 66,000 |
| Maximum Zero Fuel Weight | 137,789 | 62,500 |
| Basic Empty Weight | 94,471 | 42,851 |
| Date of Last Weighing | 10/19/2014 | |
| Weight Variant 012 | | |

FUEL

| | <u>Pounds</u> | <u>Kilograms</u> | <u>Gallons</u> |
|-------------------------|---------------|------------------|----------------|
| Standard Fuel Capacity | 42,210 | 19,141 | 6,300 |
| Auxiliary Tank Capacity | N/A | N/A | N/A |

INTERIOR CONFIGURATION

| | | | |
|-----------------------|------------|-----------------------|-------|
| Galleys | G1, G2, G5 | Catering Standard | Atlas |
| Lavatories | LA, LD, LE | Cockpit Configuration | EFIS |
| Cabin Attendant Seats | 6 | | |

| | <u>Quantity</u> | <u>Manufacturer</u> | <u>Part Number</u> |
|--------------------------------|-----------------|---------------------|---------------------|
| Seats Business Class | 16 | Recaro | 409-21-21-11 |
| Economy | 120 | Recaro | 3510A549-32 -051 |

MISCELLANEOUS

| | | | |
|------------------------|-----------------|---------------------|--------------------|
| Airstairs | N/A | Cargo Configuration | Bulk |
| Noise Compliance | Stage 4 | Floor Path Marking | Yes |
| Approach / Landing Cat | CAT III Capable | Entertainment | Panasonic Avionics |

Modification Status

| | <u>Installed</u> | <u>Approval</u> |
|--------------------------|------------------|-----------------|
| 8.33 KHz Spacing | Yes | Build Standard |
| RVSM Approved | Yes | Build Standard |
| 406 ELT | Yes | Build Standard |
| Cargo Fire Suppression | Yes | Build Standard |
| Flight Deck Door | Yes | Build Standard |
| Re-enforcement | | |
| FM immunity | Yes | Build Standard |
| Flight Deck Surveillance | Yes | Build Standard |

No warranty is made or implied as to the accuracy or completeness of the information herein.
Such information is subject to change and to verification upon inspection of the aircraft and its records

**AIRCRAFT TECHNICAL
SPECIFICATION**

Report generated 13 Apr 2018

Enhanced Mode S
TCAS II C.7.0

Yes
Yes

Build Standard
Build Standard

No warranty is made or implied as to the accuracy or completeness of the information herein.
Such information is subject to change and to verification upon inspection of the aircraft and its records

| |
|---|
| AIRCRAFT TECHNICAL SPECIFICATION |
|---|

Report generated 13 Apr 2018

AIRFRAME

OEM Maintenance Program

| <u>Check</u> | <u>Interval Hours</u> | <u>Interval Cycles</u> | <u>Interval</u> | <u>Program Basis</u> |
|---------------|-----------------------|------------------------|-----------------|----------------------|
| 12 Year Check | | | 144.00 Months | Hardtime |
| 6 Year Check | | | 72.00 Months | Hardtime |
| C Check | 7,500 | 5,000 | 24.00 Months | Hardtime |

Operator Maintenance Program

| <u>Check</u> | <u>Operator Equivalent</u> | <u>Interval Hours</u> | <u>Interval Cycles</u> | <u>Interval</u> | <u>Program Basis</u> |
|---------------|----------------------------|-----------------------|------------------------|-----------------|----------------------|
| 12 Year Check | None | | | | |
| 6 Year Check | None | | | | |
| C Check | C Check | 7,500 | 5,000 | 24.00 | Hardtime |

Maintenance Status

Total Time 26,052
 Total Cycles 16,567
 Status As Of 31 Mar 2018

| <u>Check</u> | <u>Maintenance Performer</u> | <u>Date of Check</u> | <u>TT @ Check</u> | <u>TC @ Check</u> | <u>Est Date Next Check</u> |
|---------------|------------------------------|----------------------|-------------------|-------------------|----------------------------|
| 12 Year Check | N/A | Not Performed | N/A | N/A | Dec 22 |
| 6 Year Check | xxxx | 05 Nov 16 | 20,431.00 | 13,130 | Nov 22 |
| C Check | xxxx | 05 Nov 16 | 20,431.00 | 13,130 | Sep 18 |

LANDING GEAR

Maintenance Program

Manufacturer Messier Dowty

| <u>Description</u> | <u>Interval Hours</u> | <u>Interval Cycles</u> | <u>Interval</u> | <u>Program Basis</u> |
|--------------------------------|-----------------------|------------------------|-----------------|----------------------|
| NLG - Landing Gear Overhaul | | 20,000 | 120.00 Months | Hardtime |
| LH MLG - Landing Gear Overhaul | | 20,000 | 120.00 Months | Hardtime |
| RH MLG - Landing Gear Overhaul | | 20,000 | 120.00 Months | Hardtime |

Maintenance Status

| | <u>Nose</u> | <u>LH Wing</u> | <u>RH Wing</u> |
|----------------------|---------------|----------------|----------------|
| Part Number | D23757550-7 | 201581001 | 201582002-050 |
| Serial Number | B4086 | MDG6457 | MDG6458 |
| Date Installed | 22 Dec 2010 | 22 Dec 2010 | 22 Dec 2010 |
| TSN | 26,052 | 26,052 | 26,052 |
| CSN | 16,567 | 16,567 | 16,567 |
| Status As Of | 31 Mar 2018 | 31 Mar 2018 | 31 Mar 2018 |
| Date Overhauled | Not Performed | Not Performed | Not Performed |
| TSO | N/A | N/A | N/A |
| CSO | N/A | N/A | N/A |
| Estimated Next Visit | Aug 2019 | Aug 2019 | Aug 2019 |

No warranty is made or implied as to the accuracy or completeness of the information herein.
 Such information is subject to change and to verification upon inspection of the aircraft and its records

| |
|---|
| AIRCRAFT TECHNICAL SPECIFICATION |
|---|

Report generated 13 Apr 2018

ENGINE

| | | | |
|--------------|-------------|---------------|--------|
| Manufacturer | CFMI | Engine Thrust | 27,000 |
| Engine Model | CFM56-5B4/3 | | |

Engine Position 1 Maintenance Status

| | | | | | |
|-------|--------|---------------|-------------|-----------------|-------------|
| ESN 1 | xxxxxx | Date Last S.V | 14 Apr 2014 | LLP Limiter | Multiple |
| TSN | 26,264 | TS Last S.V | 15,336 | Limiting Cycles | 6,257 |
| CSN | 13,743 | CS Last S.V | 7,832 | Status As Of | 31 Mar 2018 |

Engine Position 2 Maintenance Status

| | | | | | |
|-------|--------|---------------|-------------|-----------------|----------------|
| ESN 2 | xxxxxx | Date Last S.V | 17 Feb 2018 | LLP Limiter | LPT [Multiple] |
| TSN | 23,391 | TS Last S.V | 24 | Limiting Cycles | 11,916 |
| CSN | 13,084 | CS Last S.V | 92 | Status As Of | 31 Mar 2018 |

APU

| | |
|---------------|-----------------------------|
| Manufacturer | Honeywell International Inc |
| Type / Model | GTCP131-9A |
| Serial Number | P-4670 |

Contracted APU Maintenance Status

| | |
|-------------------------|-------------------------------|
| Date of Last Overhaul | 27 Jun 2016 |
| Date of Last Shop Visit | 27 Jun 2016 |
| Reason for Shop Visit | TURBINE SECTION DETERIORATION |

No warranty is made or implied as to the accuracy or completeness of the information herein.
Such information is subject to change and to verification upon inspection of the aircraft and its records

| |
|---|
| AIRCRAFT TECHNICAL SPECIFICATION |
|---|

Report generated 13 Apr 2018

EQUIPMENT

| ATA | Description | Qty | Manufacturer | Model/PN |
|------------|--|------------|--------------------------------|-----------------------|
| 22 | Flight Augmentation Computer - 1CC2/1CC1 | 2 | Thales Avionics | B397BAM0624 |
| 22 | Flight Control Unit - 2CA | 1 | Thales Avionics | C12850BC03 |
| 22 | Flight Management Computer - 1CA2/1CA1 | 2 | Thales Avionics | C13043AA05 |
| 22 | MCDU - 3CA1/3CA2 | 2 | Thales Avionics | C19266DA01/C19266EA01 |
| 23 | Cockpit Voice Recorder - 1RK | 1 | Honeywell International Inc | 980-6022-001 |
| 23 | HF Communications Transceiver - 3RE1 | 1 | Rockwell Collins | 822-0990-003 |
| 23 | VHF Transceiver - 1RC3/1RC1/1RC2 | 3 | Rockwell Collins | 822-1287-120 |
| 25 | Emergency Locator Transmitter - 110MX | 1 | Kannad | S1821502-02 |
| 25 | Alternate part number also fitted, see below Emergency Locator Transmitter - 7559MM/7560MM | 2 | Kannad | S1823502-05 |
| 31 | CFDIU - 1TW | 1 | Thales Avionics | C12860AA02 |
| 31 | Display Management Computer - 1WT1 / 1WT12/ 1WT3 | 3 | Thales Avionics | 1982660116 |
| 31 | Display Unit - 3WT2/2WT1/3WT1/4WT1/4WT2/2WT2 | 6 | Thales Avionics | C19298AF05 |
| 31 | SSFDR - 1TU | 1 | Honeywell International Inc | 980-4700-042 |
| 32 | Brake Assy - MLG - 2641GM / 2644GM/ 2642GM | 3 | Messier Bugatti | C20225510 |
| 32 | Alternate part also fitted, see below Brake Assy - MLG - 2643GM | 1 | Messier Bugatti | C20225509 |
| 32 | Fan Brakes - 2867GM/2868GM/2869GM/2866GM | 4 | Techno fan | RU1502U01 |
| 32 | Tyre MLG - 2649GM/2652GM/2651GM/2650GM | 4 | Michelin Air X | M01103 |
| 32 | Tyre NLG - 2659GM/2660GM | 2 | Michelin Air X | M08201 |
| 32 | Wheel Assy - MLG - 2651GM/2649GM/2650GM/2652GM | 4 | Messier Bugatti | C20195162 |
| 32 | Wheel Assy - NLG - 2659GM/2660GM | 2 | Goodrich | 3-1531 |
| 34 | ADF Receiver - 2RP1 | 1 | Rockwell Collins | 822-0299-020 |
| 34 | ADIRU - 1FP3/1FP1/1FP2 | 3 | Honeywell International Inc | HG2030BE03 |
| 34 | Air Data Module - 19FP4/19FP5/19FP6/19FP7/19FP8/19 | 8 | Honeywell International Inc | PG1152BC02 |
| 34 | DME Interrogator - 2SD1/2SD2 | 2 | Rockwell Collins | 822-0329-020 |
| 34 | EGPWC Mark 5 - NOT AVAILABLE | 1 | Honeywell International Inc | 965-1676-002 |
| 34 | ISIS - 22FN | 1 | Thales Avionics | C16221WB01 |
| 34 | MMR Receiver - 40RT2/40RT1 | 2 | Rockwell Collins | 822-1821-430 |
| 34 | Radio Altimeter - Transceiver - 2SA1/2SA2 | 2 | Rockwell Collins | 822-0334-020 |
| 34 | T3CAS - 1000-SG | 1 | L-3 Communications | 9005000-10204 |
| 34 | VOR/Marker Receiver - 3RS1/3RS2 | 2 | Rockwell Collins | 822-0297-020 |
| 34 | Weather Radar Tx/Rx - 1SQ1 | 1 | Rockwell Collins | 822-1710-214 |
| 73 | Engine ECU - LH/RH | 2 | CFMI | 2123M56P04 |

Comments

For technical inquiries please contact:

Phone:
Mobile:
Fax:
e-mail:

No warranty is made or implied as to the accuracy or completeness of the information herein.
Such information is subject to change and to verification upon inspection of the aircraft and its records

AIRCRAFT TECHNICAL SPECIFICATION

Report generated 13 Apr 2018

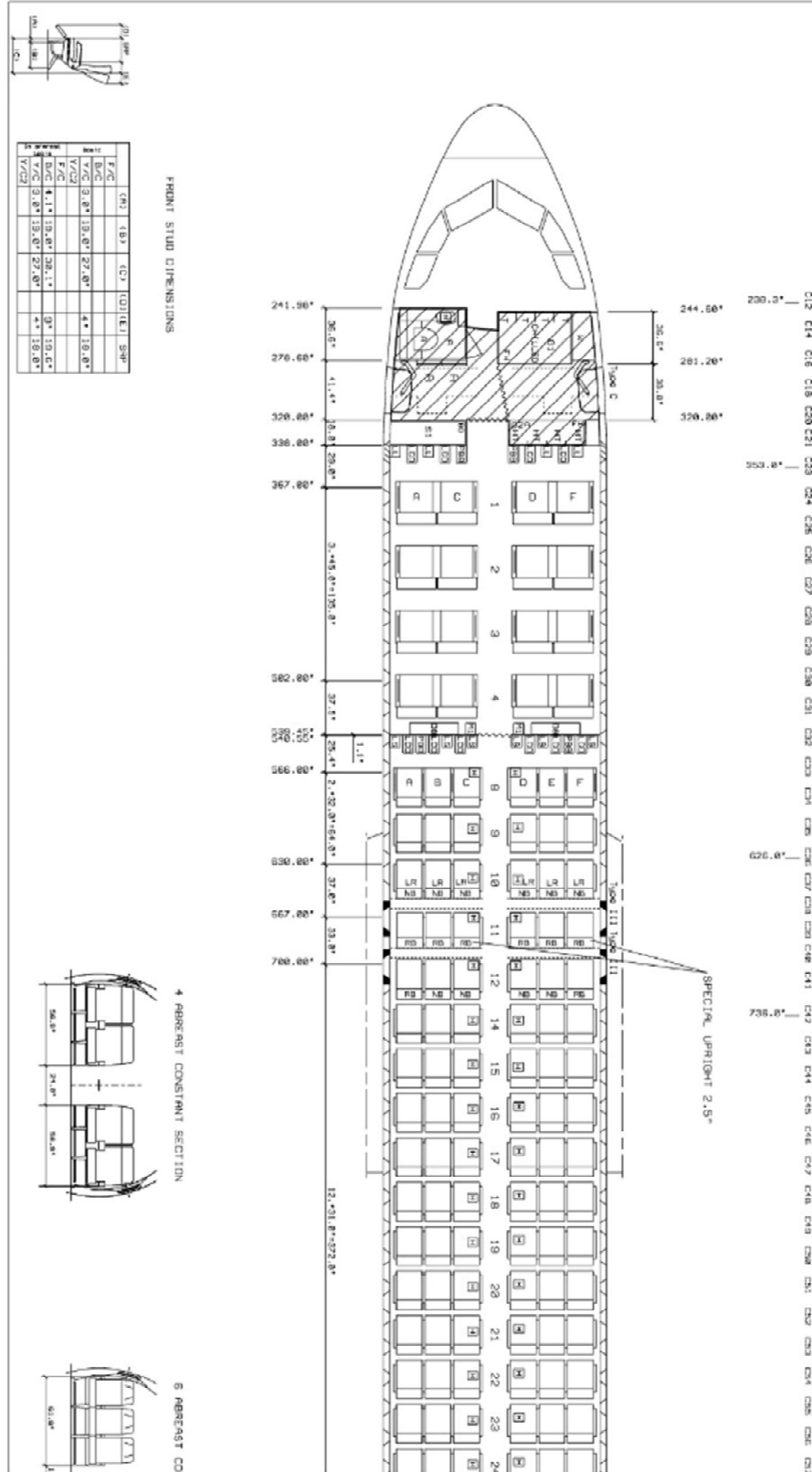

AIRCRAFT TECHNICAL SPECIFICATION

Report generated 13 Apr 2018

